



21 Chaucer Street, Leicester, LE2 1HD

ALL VIEWINGS, ENQUIRIES AND OFFERS ARE TO BE SUBMITTED THROUGH RENTMYHOME.CO.UK WEBSITE

Rent My Home proudly offer this stylish ONE BEDROOM APARTMENT located on Chaucer Street, Leicester, LE2. This property is available view NOW, and move in from ASAP, so call today to book your viewing!

This duplex apartment comprises of a kitchen, bedroom and bathroom on the ground floor with an open lounge space on the first floor which makes the space on offer unique. There is also direct access into a private and self-contained rear garden from the ground floor which adds to the appeal of this property.

Chaucer Street is situated close by to the popular London Road, Queens Road and Victoria Park areas so has excellent public transport links as well as bars, restaurants and shopping facilities all within walking distance so is ideal for working professionals or students to move in.

£725 PCM

21 Chaucer Street

, Leicester, LE2 1HD



- *** ONE BEDROOM APARTMENT ***
- Spacious Double Bedroom
- Good Quality Electric Heating
- Available from NOW
- Unfurnished Accommodation
- Separate Upstairs Lounge Area
- Double Glazed Windows
- Modern Fitted Kitchen with White Appliances
- Stylish Fitted Bathroom
- Ideal for Working Professionals or Students



Directions

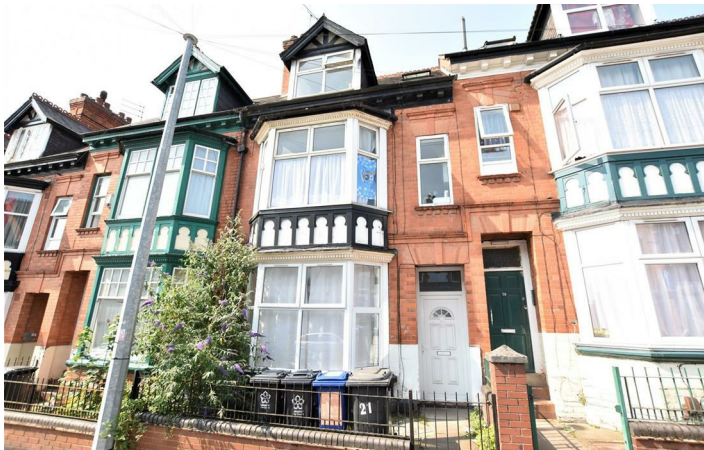

Floor Plan

Ground Floor
Approx. 25.5 sq. metres (273.9 sq. feet)

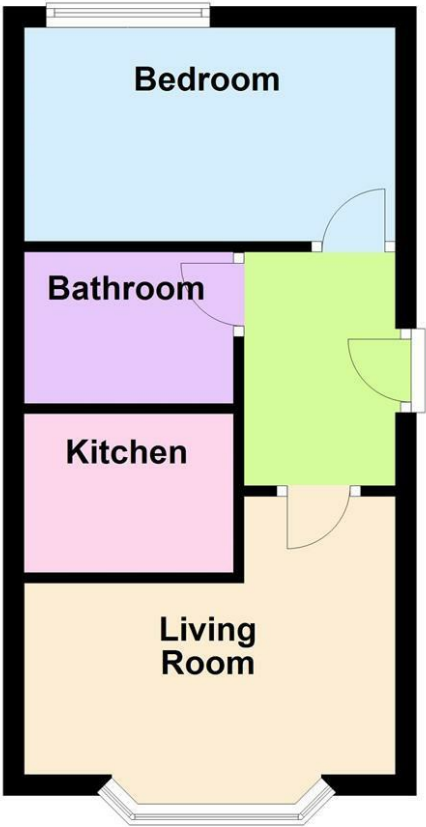

Total area: approx. 25.5 sq. metres (273.9 sq. feet)

These particulars, whilst believed to be accurate are set out as a general outline only for guidance and do not constitute any part of an offer or contract. Intending purchasers should not rely on them as statements of representation of fact, but must satisfy themselves by inspection or otherwise as to their accuracy. No person in this firms employment has the authority to make or give any representation or warranty in respect of the property.

